

# BARBICAN® IMPERIAL A1 (SR1)

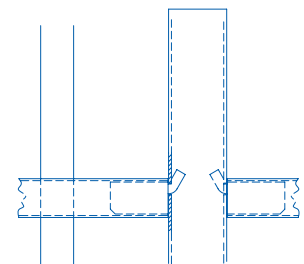

Barbican® Imperial LPS 1175 A1 (SR1 ) system of fencing and gates features a welded pale-through-rail construction for strength and security integrity. The horizontal railed are sleeved on to the upright posts with concealed fixings to provide timeless design suitable for most settings.

- LPS 1175 A1 (SR1) Approved
- Secured by Design Preferred Specification
- Fully welded pale-through-rail construction
- Seamless, concealed rail to post fixing
- Anti-climb design
- 25-year service life guarantee



Post to panel fixings

## APPLICATIONS

- ✓ Medium risk
- ✓ Schools
- ✓ Retail
- ✓ Public spaces

## PANELS

Barbican® Imperial SR1 has vertical round hollow section 32mm diameter pales up to 2000mm high at 124mm centres and 32mm for 2100mm+ with 129mm centres which complies to Building Regulations.

## GATES

A1 (SR1) gates available

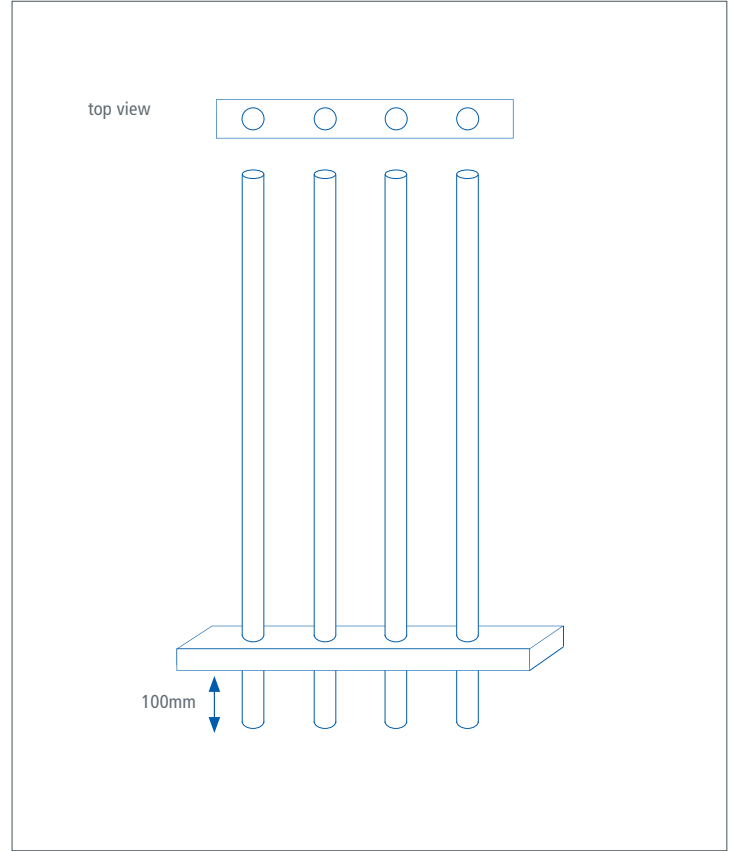

HEIGHT (MM)	POST CENTRES (MM)	POST DIMENSIONS (MM)	OVERALL POST LENGTH (MM)
1800	3000	80 x 60	2500
2000	3000	80 x 60	2800
2500	3000	80 x 60	3300
3000	2484	80 x 60	3800

## FINISHES

- Hot dip galvanised to BS EN ISO 1461 as standard
- Hot dip galvanised and powder coated to BS EN 13438
- Marine coat for installations within 500m of salt water or an estuary

## STANDARD COLOURS

- Black RAL 9005
- Green RAL 6005
- Other colours are available on request

## APPROVALS

LPS 1175 A1 (SR1)

