

OPTION 'A'
ROUND POST

BOWTOP FENCE ON CRANKED POSTS

OPTION 'B'
SQUARE POST

OPTION 'A'
ROUND POSTS

OPTION 'B'
SQUARE POSTS

NOTES.

ALL DIMENSIONS ARE IN mm (UNO)
GAPS UNDER FENCING ARE
NOMINAL DUE TO GROUND LEVELS.

MATERIALS.

FENCE POST: ϕ 60.3 CHS (TYPICALLY)
OR 60 x 60 SHS (TYPICALLY)
POSTS ASSESSED TO SUIT SITE LOCATION
RAILS: 50 x 25 RHS
PALES: ϕ 19 CHS

FINISH.

GALVANISED TO BS EN ISO 1461
POWDER COATED: IF REQUESTED

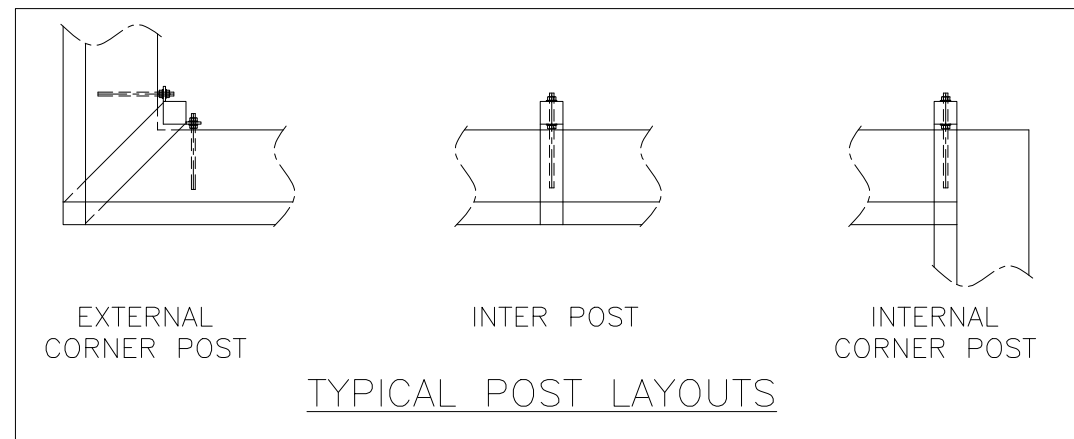

Stowting Common, Near Ashford,
Kent. TN25 6BN
Telephone: 01233 750393
Fax: 01233 750403
www.jacksons-fencing.co.uk

DO NOT SCALE – IF IN DOUBT ASK

4	26/02/2020	NEW BORDER + NOTES + REDRAWN
3	04/11/14	Option B Fixing Removed
2	19/04/08	Post Centres
1	16/09/06	Hole Positions Added
0	06/06/06	Original Issue

Drawn	S.Leeper
Date	06/06/06
Checked	CJ
Size	A3
Scale	1:20 U.O.S

TITLE	SALES DRAWING	
	BOWTOP FENCE – CRANKED POSTS	
CUSTOMER		
ACK No.		
Drawing No.	J1/01074	
	Sheet 3	

This Drawing Is The Property Of H.S. Jackson & Son (Fencing) Ltd, And May Not Be Copied Or Reproduced In Any Way Without Prior Written Permission.