

**NOTES.**

ALL DIMENSIONS ARE IN mm (U.N.O)  
GAP UNDERNEATH GATE IS BASED  
UPON THE SITE BEING LEVEL.

**MATERIALS.**

POST FRAME:  $\phi 60.3$  CHS  
GATE FRAME:  $\phi 41.5$  CHS

**FITTING REQUIRED.**

- 2 No. 2m STRETCHER BAR (335930)
- 6 No. FERRULE STRAINER (342400)
- 10 No. STRAP FOR  $\phi 60.3$  (065011)
- 10 No. M8 x 50 Lg BOLT, NUT & WASHER
- 6 No. EXTRA M8 NUT

**FINISH.**

GALVANISED TO BS EN ISO 1461  
POWDER COATED IF REQUIRED

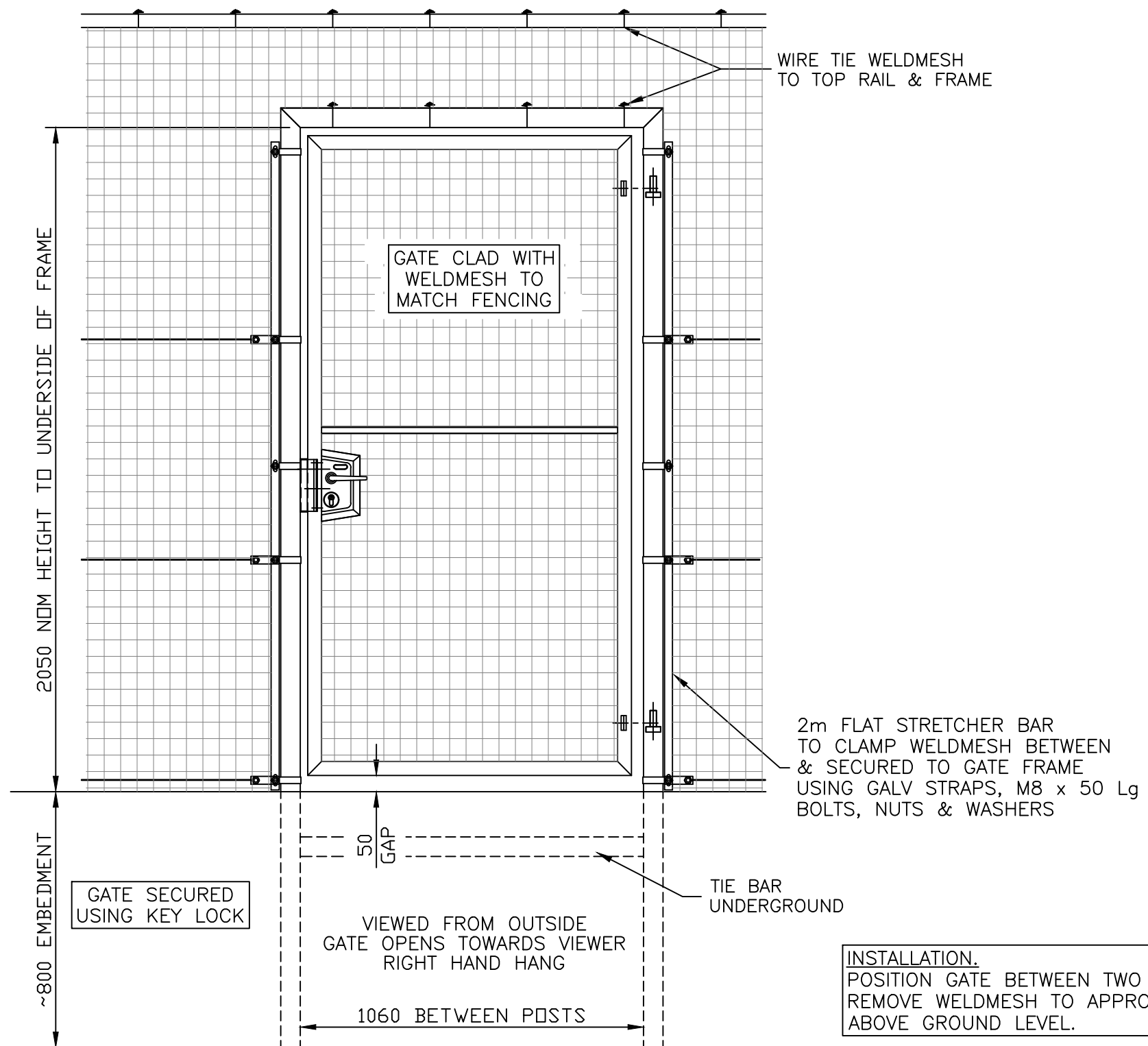

**Jacksons Fencing**

Stowting Common, Near Ashford,  
Kent. TN25 6BN  
Telephone: 01233 750393  
Fax: 01233 750403  
www.jacksons-fencing.co.uk  
www.jacksons-security.co.uk

DO NOT SCALE – IF IN DOUBT ASK

- ③ 04/03/2020 NEW BORDER + NOTES
- ② 20/12/13 UPDATED
- ① 06/01/06 UPDATED
- ① 05/12/01 ORIGINAL ISSUE

Drawn JR  
Date 28/02/2002  
Checked CJ  
Size A3  
Scale 1:16 U.O.S

TITLE SALES & INSTALLATION DRAWING FOR  
SINGLE WELDMESH TENNIS COURT GATE  
CUSTOMER  
ACK No.  
Drawing No.  
J2/04040  
Sheet 3

This Drawing Is The Property Of H.S. Jackson & Son (Fencing) Ltd, And May Not Be Copied Or Reproduced In Any Way Without Prior Written Permission.