

BASEPLATE SLOTTED FOR M12 CHEMICAL FIXINGS

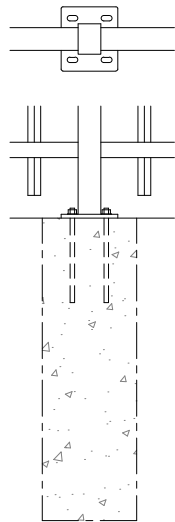

OPTIONAL  
BASEPLATED POSTS

**NOTES.**

ALL DIMENSIONS ARE IN mm (UNO)  
GAPS UNDER FENCING ARE NOMINAL DUE TO GROUND LEVELS.  
FOUNDATION SIZES ARE DEPENDANT UPON SITE CONDITIONS.

**MATERIALS.**

FENCE POST: 80 x 60 RHS (TYPICAL)  
(ASSESSED TO SUIT SITE LOCATION)

RAILS: 60 x 40 RHS

PALES: 25 x 25 SHS

**FINISH.**

GALVANISED TO BS EN ISO 1461  
POWDER COATED: IF REQUESTED

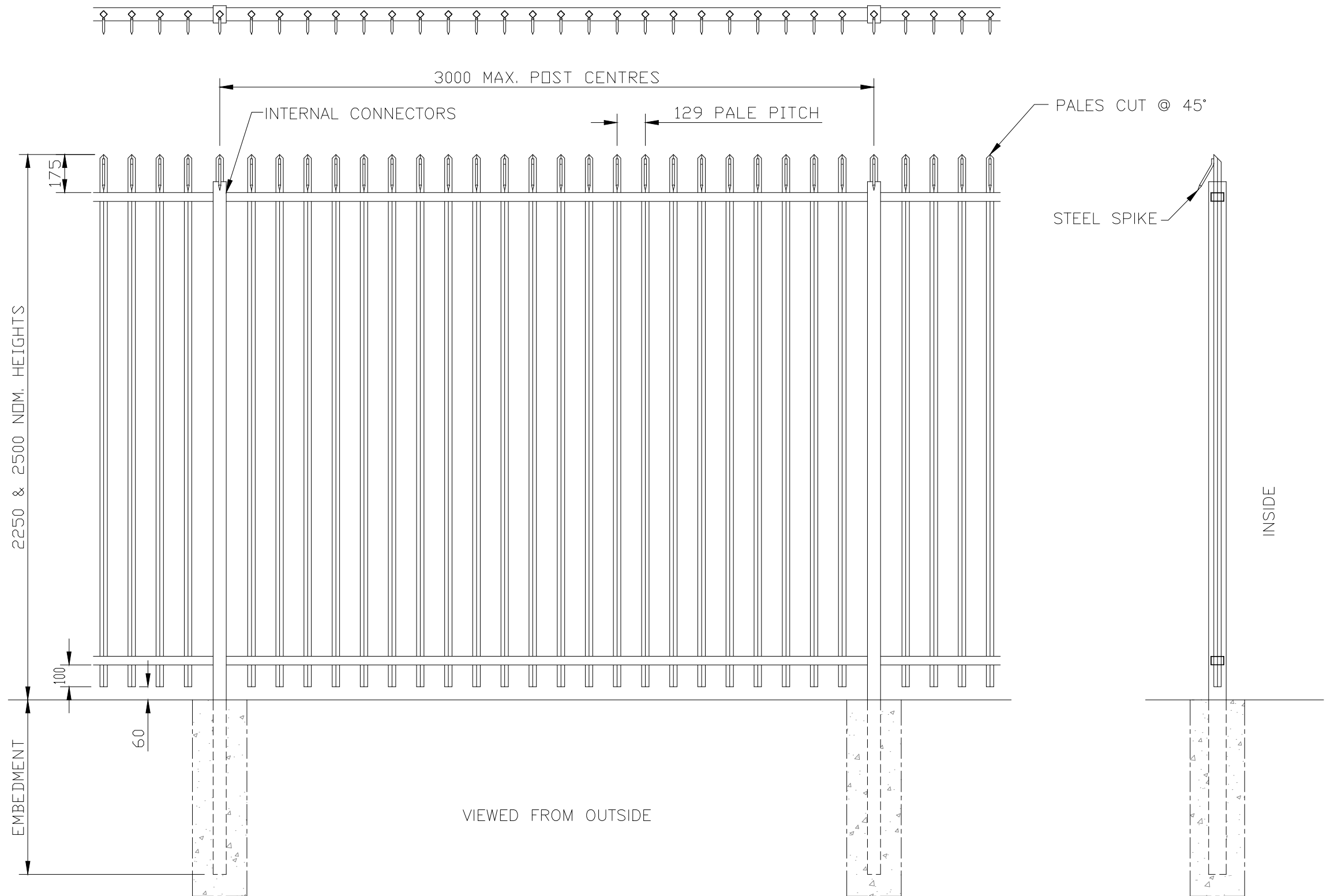

**Jacksons Fencing**

Stowting Common, Near Ashford,  
Kent. TN25 6BN  
Telephone: 01233 750393  
Fax: 01233 750403  
www.jacksons-fencing.co.uk

DO NOT SCALE – IF IN DOUBT ASK

- ③ 27/02/2020 NEW BORDER + NOTES
- ② 25/01/10 UPDATED
- ① 10/11/09 POST EMBEDMENT
- ① 02/01/04 Original Issue

Drawn S.Leeper  
Date 02/01/2004  
Checked CJ  
Size A3  
Scale 1:20 U.O.S

TITLE SALES DRAWING – 2.25m & 2.5m HIGH  
BARBICAN BARBED TOP FENCE

CUSTOMER

Drawing No.

J1/01085

ACK No.

Sheet 1

This Drawing Is The Property Of H.S. Jackson & Son (Fencing) Ltd, And May Not Be Copied Or Reproduced In Any Way Without Prior Written Permission.