

BASEPLATE SLOTTED FOR M12 CHEMICAL FIXINGS

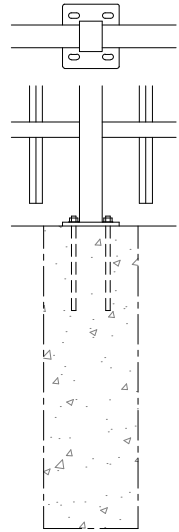

OPTIONAL
BASEPLATED POSTS

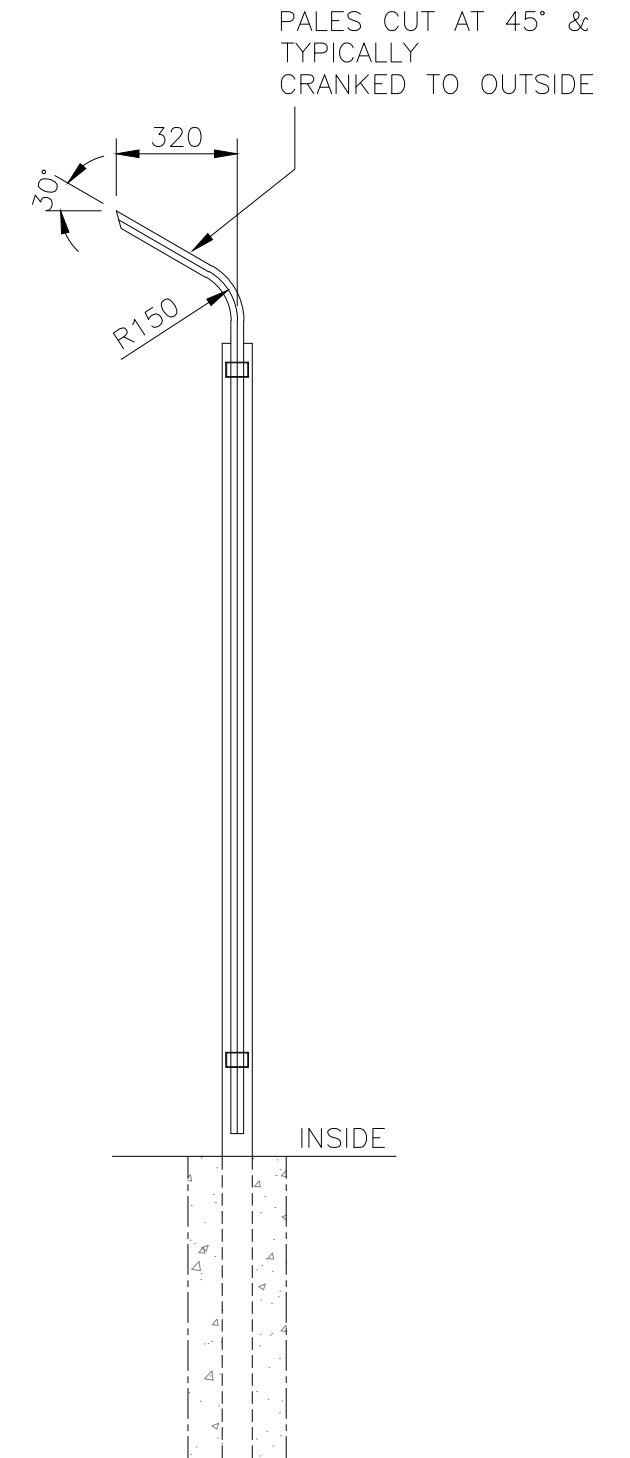
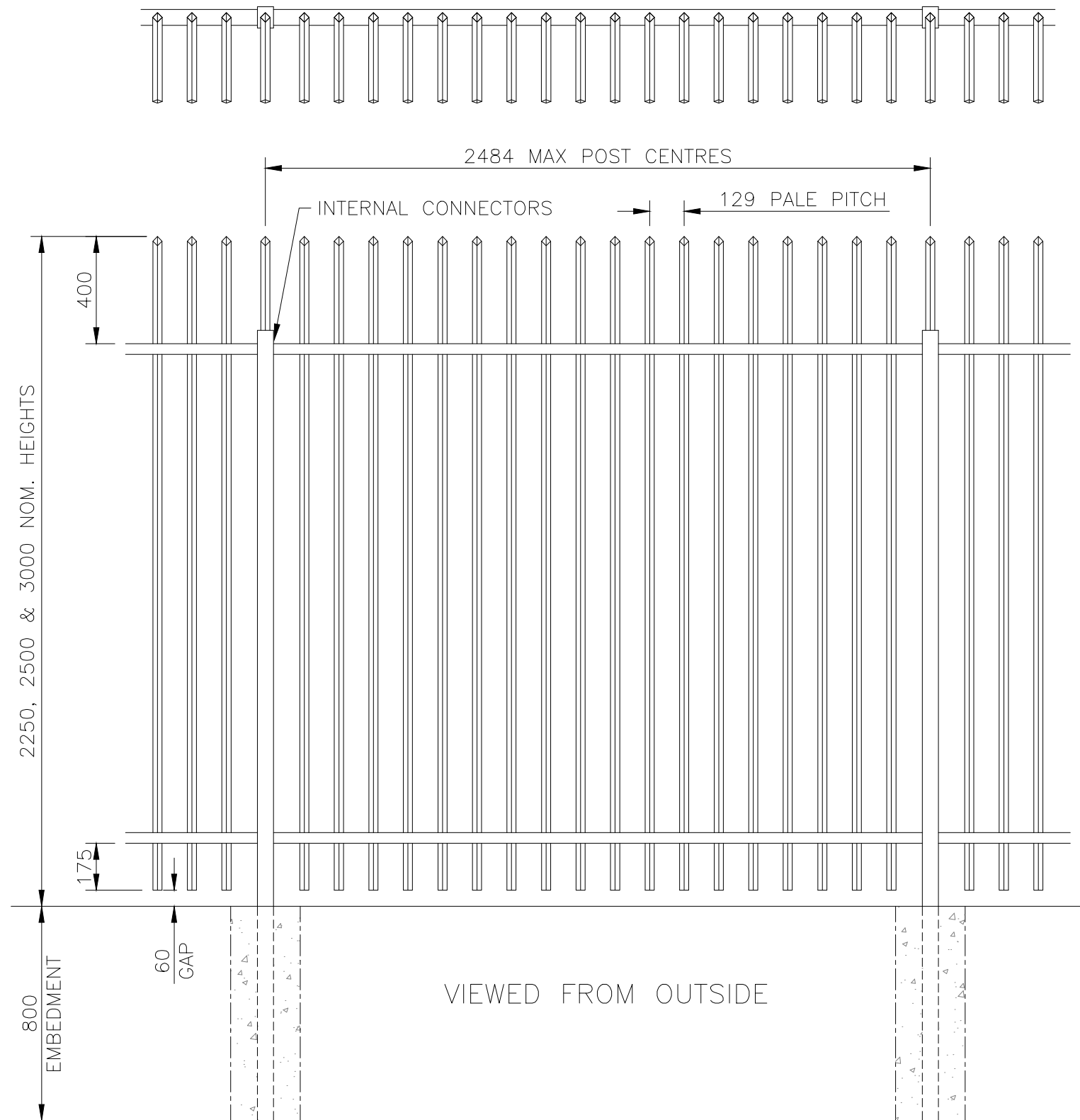

NOTES.

ALL DIMENSIONS ARE IN mm (UNO)
GAPS UNDER FENCING ARE NOMINAL DUE TO GROUND LEVELS.
FOUNDATION SIZES ARE DEPENDANT UPON SITE CONDITIONS.

MATERIALS.

FENCE POST: 80 x 60 RHS

RAILS: 60 x 40 RHS

PALES: 25 x 25 SHS

FINISH.

GALVANISED TO BS EN ISO 1461

POWDER COATED: IF REQUESTED

Jacksons Fencing

Stowting Common, Near Ashford,
Kent. TN25 6BN
Telephone: 01233 750393
Fax: 01233 750403
www.jacksons-fencing.co.uk

DO NOT SCALE – IF IN DOUBT ASK

- 5 26/02/2020 NEW BORDER + NOTES
- 4 29.01.14 Galv Note Updated
- 3 25/01/10 BASE NOTE
- 2 29/10/09 SHEET No.
- 1 29/02/08 Updated To 'Extreme'

Drawn Chris J
Date 09/07/04
Checked CJ
Size A3
Scale 1:20 U.O.S

TITLE SALES DRAWING
BARBICAN DEFENDER XTREME FENCE
CUSTOMER
Drawing No. J1/01071
Sheet 1
ACK No.

This Drawing Is The Property Of H.S. Jackson & Son (Fencing) Ltd, And May Not Be Copied Or Reproduced In Any Way Without Prior Written Permission.