

FOR OPTIONAL FINIAL TOPPINGS
REFER TO DRAWING J1/01064

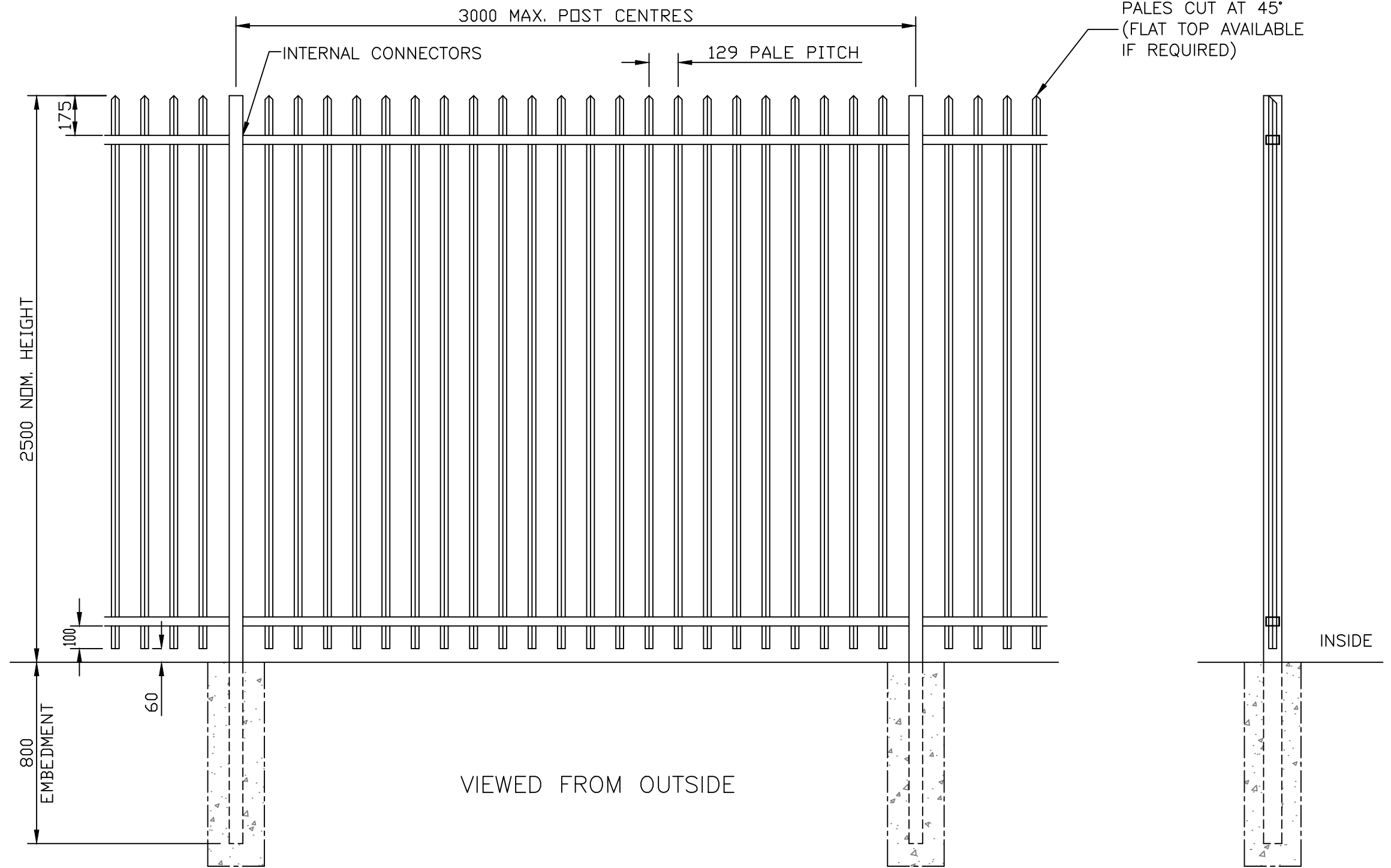

BASEPLATE SLOTTED FOR
M12 CHEMICAL FIXINGS

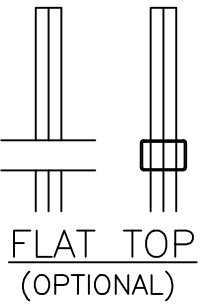
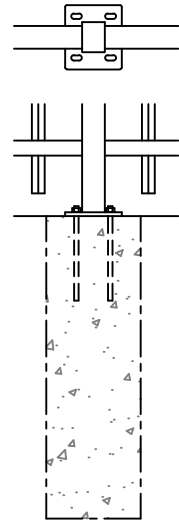

OPTIONAL
BASEPLATED POSTS

NOTES.

ALL DIMENSIONS ARE IN mm (UNO)
GAPS UNDER FENCING ARE
NOMINAL DUE TO GROUND LEVELS.
FOUNDATION SIZES ARE DEPENDANT
UPON SITE CONDITIONS.

MATERIALS.

FENCE POST: 80 x 60 RHS (TYPICAL)
(ASSESSED TO SUIT SITE LOCATION)

RAILS: 60 x 40 RHS

PALES: 25 x 25 SHS

FINISH.

GALVANISED TO BS EN ISO 1461
POWDER COATED: IF REQUESTED

**Jacksons
Fencing**

Stowting Common, Near Ashford,
Kent. TN25 6BN
Telephone: 01233 750393
Fax: 01233 750403
www.jacksons-fencing.co.uk
www.jacksons-security.co.uk

DO NOT SCALE – IF IN DOUBT ASK

- ③ 26/02/2020 NEW BORDER + NOTES
- ② 29.01.14 Galv Note Updated
- ① 22/01/10 UPDATED
- ① 23/05/00 ORIGINAL ISSUE

Drawn	CAJ
Date	23/05/00
Checked	CJ
Size	A3
Scale	1:20 U.O.S

TITLE
SALES DRAWING
2.5m HIGH BARBICAN FENCE

CUSTOMER

Drawing No.

J1/01064
Sheet 5

ACK No.

This Drawing Is The Property Of H.S. Jackson & Son (Fencing) Ltd, And May Not Be Copied Or Reproduced In Any Way Without Prior Written Permission.