

FOR OPTIONAL FINIAL TOPPINGS  
REFER TO DRAWING J1/01064

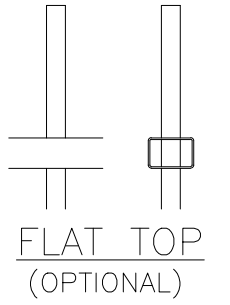

BASEPLATES SLOTTED FOR  
M12 CHEMICAL FIXINGS

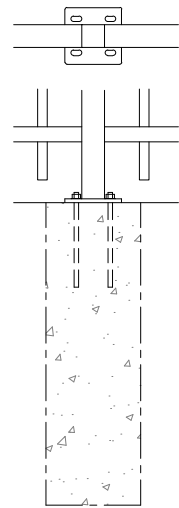

OPTIONAL  
BASEPLATED POSTS

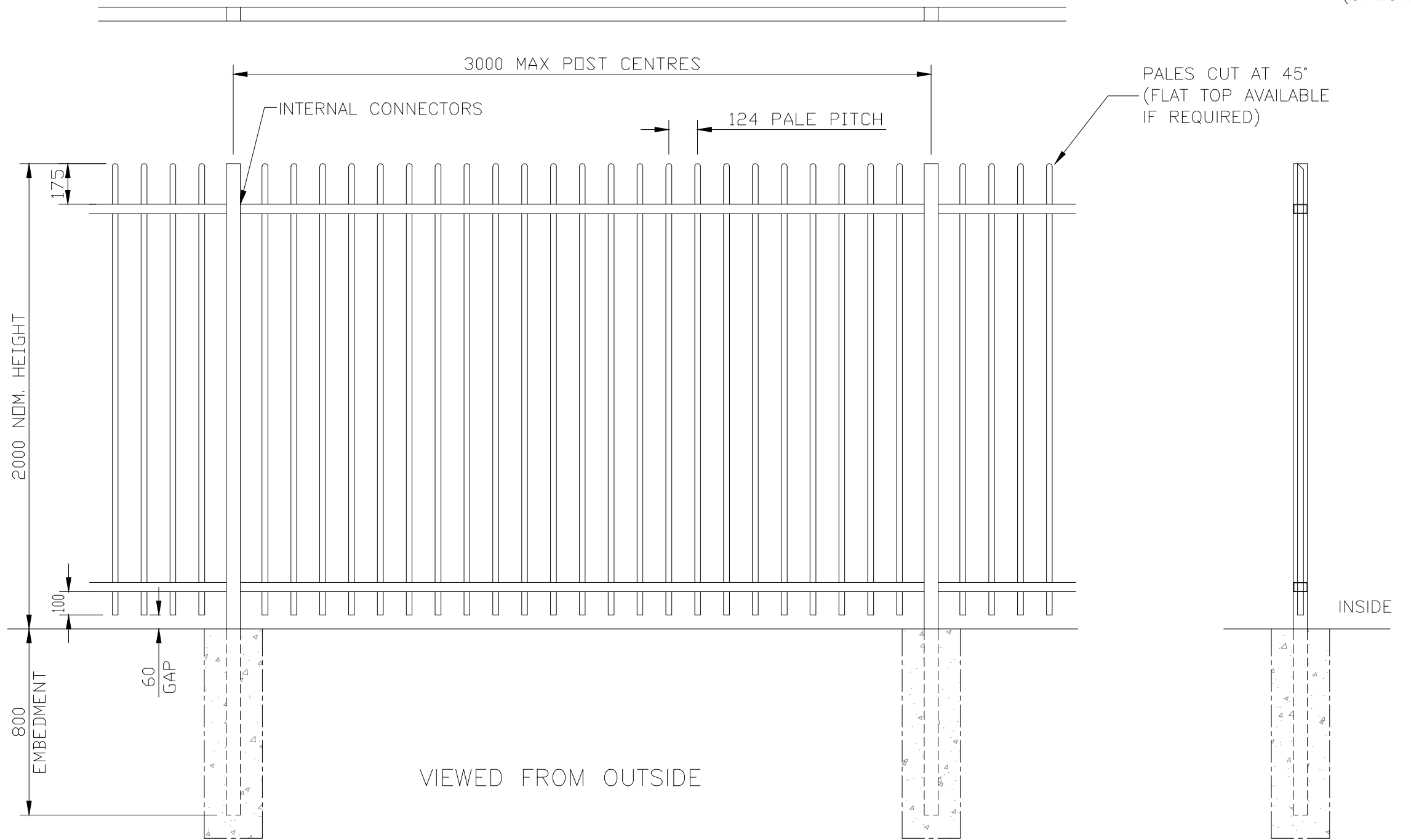

**NOTES.**

ALL DIMENSIONS ARE IN mm (UNO)  
GAPS UNDER FENCING ARE  
NOMINAL DUE TO GROUND LEVELS.  
FOUNDATION SIZES ARE DEPENDANT  
UPON SITE CONDITIONS.

**MATERIALS.**

FENCE POST: 60 x 60 SHS (TYPICAL)  
(ASSESSED TO SUIT SITE LOCATION)  
RAILS: 60 x 40 RHS  
PALES:  $\phi 25$  CHS

**FINISH.**

GALVANISED TO BS EN ISO 1461  
POWDER COATED: IF REQUESTED

VIEWED FROM OUTSIDE

**Jacksons  
Fencing**

Stowting Common, Near Ashford,  
Kent. TN25 6BN  
Telephone: 01233 750393  
Fax: 01233 750403  
www.jacksons-fencing.co.uk

DO NOT SCALE – IF IN DOUBT ASK

- ④ 26/02/2020 NEW BORDER + NOTES
- ③ 25/06/2018 BASEPLATE OPTION
- ② 29.01.14 Galv Note Updated
- ① 22/01/10 UPDATED
- ① 23/05/00 ORIGINAL ISSUE

Drawn	CAJ
Date	23/05/00
Checked	CJ
Size	A3
Scale	1:20 U.O.S

TITLE	SALES DRAWING 2m HIGH BARBICAN IMPERIAL FENCE
CUSTOMER	
ACK No.	
Drawing No.	J1/01064 Sheet 11