

TOP HINGE DETAIL  
(SCALE 1:8)

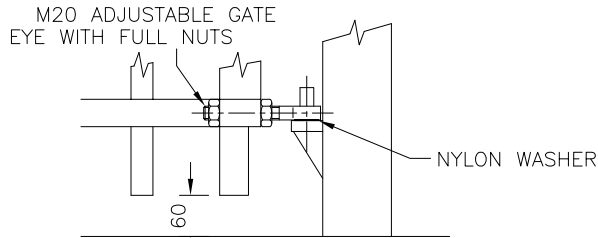

BOTTOM HINGE DETAIL  
(SCALE 1:8)

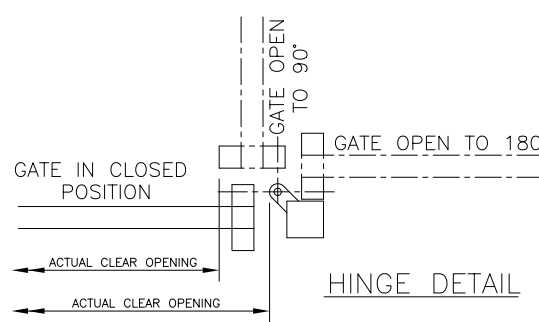

DO NOT SCALE - IF IN DOUBT ASK

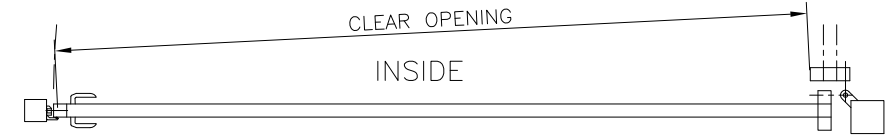
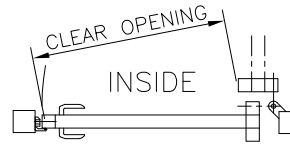
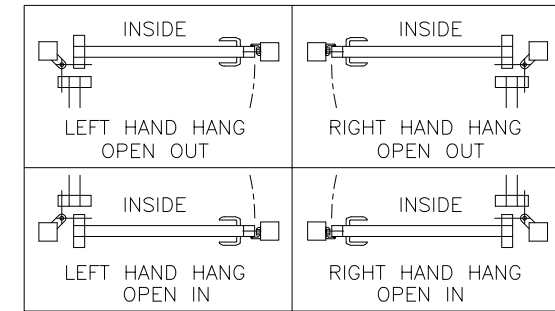

GATES SECURED USING KEY LOCK  
(REFER TO DRAWING J1/02111 FOR DETAILS)

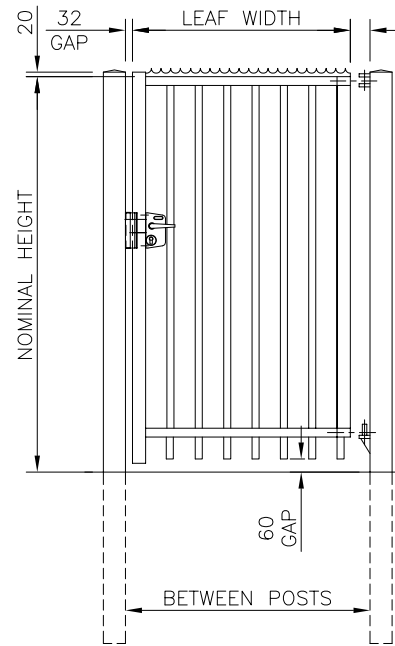

VIEWED FROM OUTSIDE  
GATE OPENS AWAY FROM VIEWER  
RIGHT HAND HANG AS SHOWN

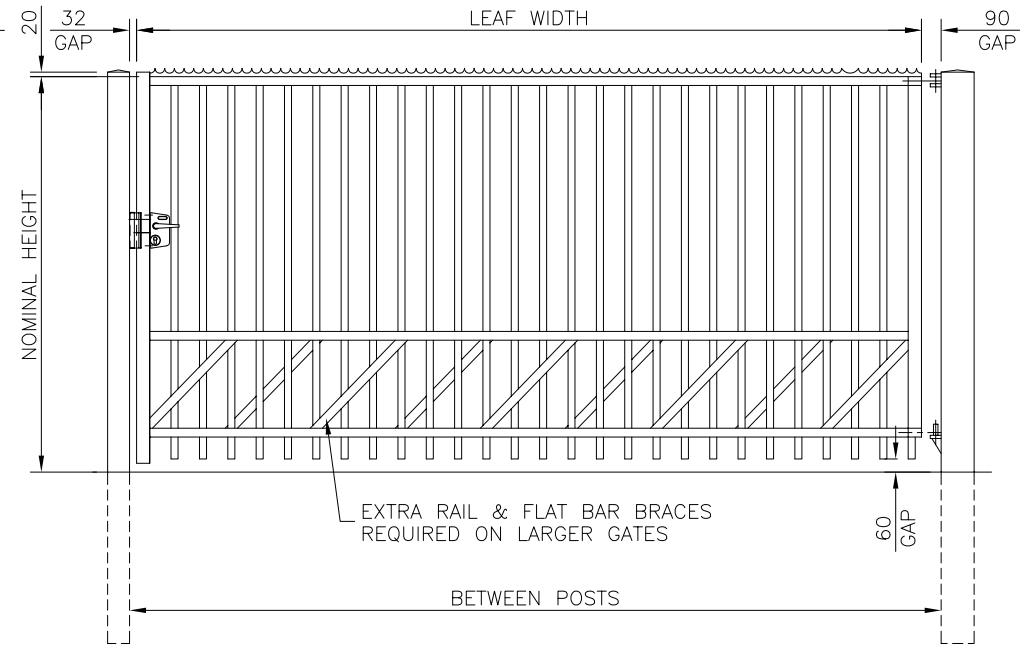

VIEWED FROM OUTSIDE  
GATE OPENS AWAY FROM VIEWER  
RIGHT HAND HANG AS SHOWN

NOTES.

ALL DIMENSIONS ARE IN mm (U.N.O)  
GAPS UNDERNEATH GATES ARE  
BASED UPON THE SITE BEING LEVEL.

PLEASE REFER TO DRAWING J1/04027  
FOR GATE SIZE RANGE & DIMENSIONS.

Materials.

- SLAM POST - 100 x 100 x 3 SHS
- HANG POST - 100 x 100 x 3 SHS  
OR 120 x 120 x 3 SHS  
OR 150 x 150 x 4 SHS
- RAILS - 60 x 40 x 2 RHS
- STILES - 60 x 60 x 2 SHS
- PALES - ø32 x 1.5 CHS

Finish.

GALVANISED TO BS EN ISO 1461:1999  
POWDER COATED IF REQUIRED

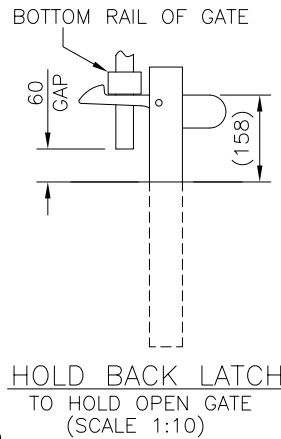

**Jacksons**  
**FINE FENCING**

Stowting Common  
Near Ashford,  
KENT. TN25 6BN  
Telephone : 01233 750393  
Fax: 01233 750403  
Int. Tel : +44 (0)1233 750393

- ⑤ 06/01/11 NOTES
- ④ 21/08/08 UPDATED TO 129 PALE PITCH
- ③ 05/01/06 UPDATED
- ② 21/03/05 DROPBOLT REMOVED
- ① 2/12/97 RAILS REVISED
- ⑥ 1/07/96 Original Issue

Drawn YH  
Date 1/7/96  
Checked  
Size A3 Scale 1:25 u.o.s

TITLE SALES & INSTALLATION DRAWING  
FOR SENTRY SINGLE GATES

CUSTOMER  
ACK No.

Drawing No.  
96 J6/02041