

DO NOT SCALE – IF IN DOUBT ASK

FOR OPTIONAL FINIAL TOPPINGS  
REFER TO DRAWING J1/01064

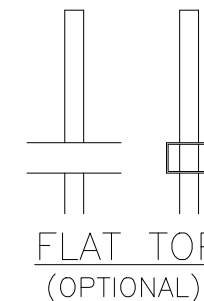

150 x 10 thk x 150  
BASEPLATE DRILLED FOR  
4 No. M12 CHEMICAL FIXINGS

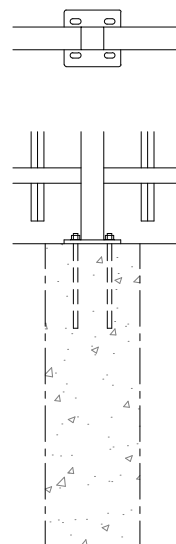

BASEPLATED POSTS  
(OPTIONAL)

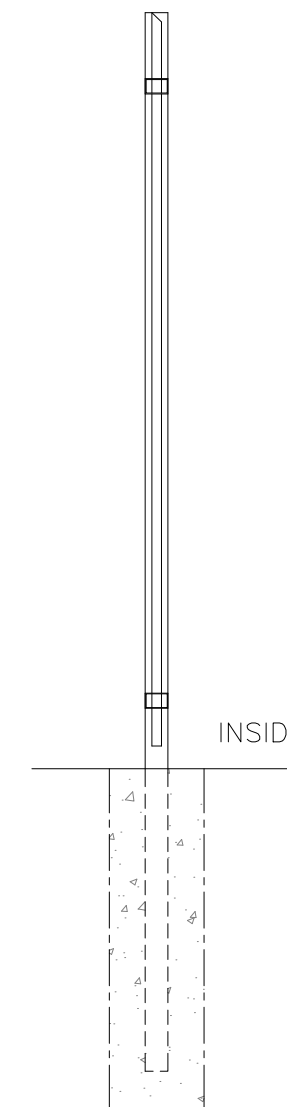
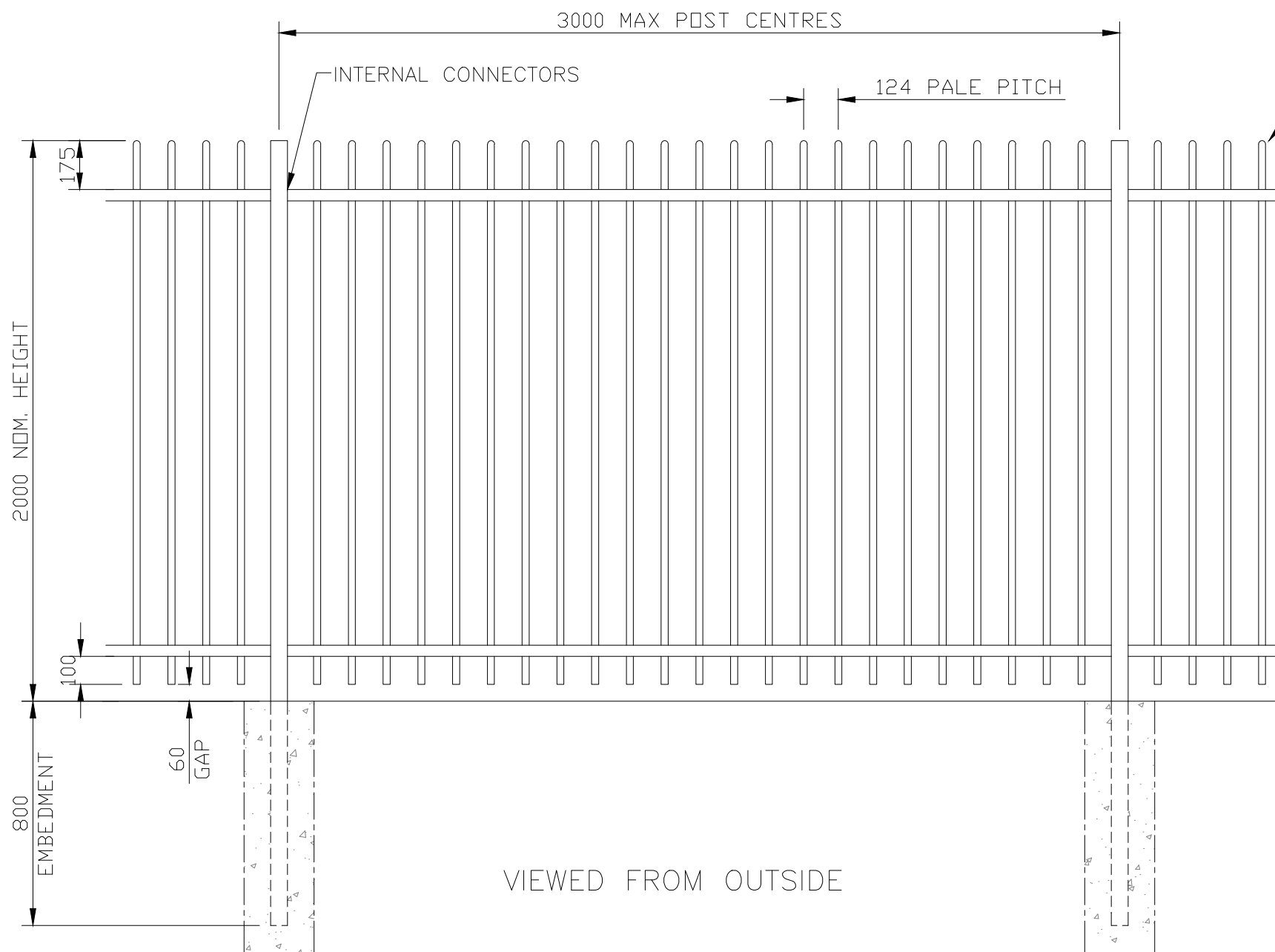

NOTES.

ALL DIMENSIONS ARE IN mm (U.N.O)  
GAPS UNDERNEATH FENCING ARE  
NOMINAL DUE TO GROUND LEVELS.  
FOUNDATION SIZES ARE DEPENDANT  
UPON SITE CONDITIONS.

Materials.

POSTS – 60 x 60 x 2 RHS  
RAILS – 60 x 40 x 2 RHS  
PALES –  $\varnothing 25$  x 1.5 CHS

Finish.

GALVANISED TO BS EN ISO 1461  
POWDER COATED: IF REQUIRED

**Jacksons**  
**FINE FENCING**

Stowting Common  
Near Ashford,  
KENT. TN25 6BN  
Telephone : 01233 750393  
Fax: 01233 750403  
Int. Tel : +44 (0)1233 750393

- ③ 25/06/2018 BASEPLATE OPTION
- ② 29.01.14 Galv Note Updated
- ① 22/01/10 UPDATED
- ① 23/05/00 ORIGINAL ISSUE

Drawn	CAJ
Date	23/05/00
Checked	
Size	Scale 1:20 U.O.S
A3	

TITLE 2m HIGH BARBICAN IMPERIAL  
FENCING SALES DRAWING

CUSTOMER  
ACK No.

Drawing No.  
00 J1/01064  
Sheet 11 of 16