

Customer Name:.....  
 Sales Order No:.....  
 Gate Height:.....  
 Gate Width:.....  
 Salesman:.....

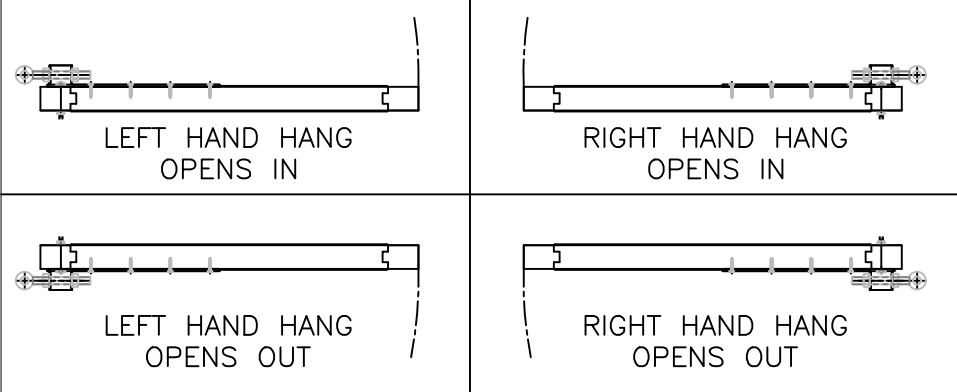

NOTE: HINGES WILL NOT BE FITTED UNLESS SPECIFICALLY REQUESTED AT POINT OF ORDER.

THE HANDING OF THE GATE IS DETERMINED BY THE POSITION OF THE HINGES AND THE DIRECTION OF THE BRACES  
 IN ALL CASES THE HANDING IS VIEWED FROM THE OUTSIDE.

PLEASE DISCUSS LOCKING REQUIREMENTS WITH SALESMAN.  
 RING LATCH, MORTICE LOCK, DIGILOCK and/or BRENTON BOLT ARE ALL OPTIONS

TIMBER BRACED GATE HAS A MAXIMUM SIZE OF 2.1m HIGH x 1.25m WIDE  
 IF LEAF IS LARGER IT WILL REQUIRE AN INTERNAL STEEL FRAME.

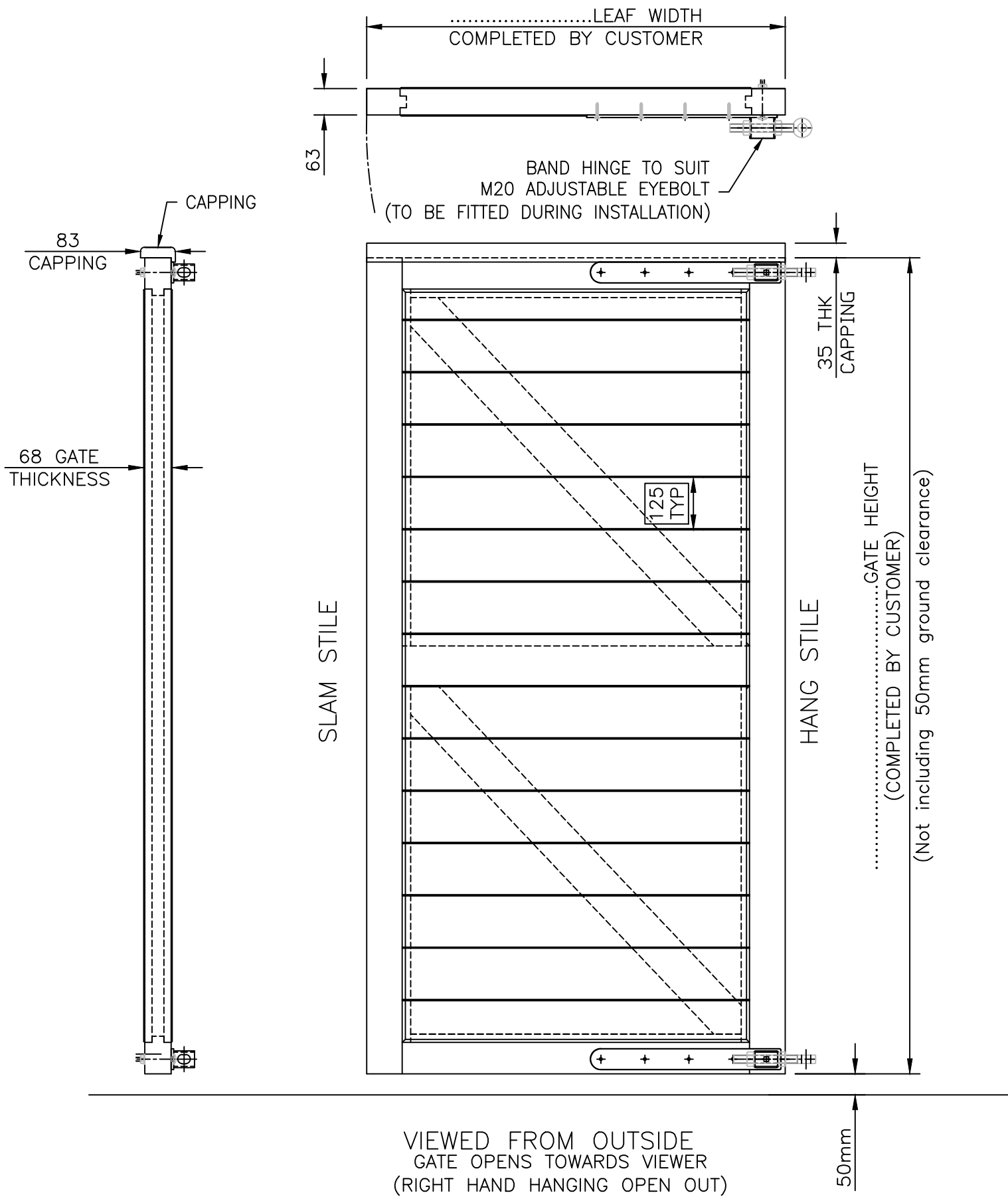

VIEWED FROM OUTSIDE  
 GATE OPENS TOWARDS VIEWER  
 (RIGHT HAND HANGING OPEN OUT)

|               |         |                  |  |
|---------------|---------|------------------|--|
| Drawn JR      | Checked |                  | ② 22/02/2023 LAYOUT UPDATED<br>① 29/09/17 Original Issue |
| Date 29/09/17 | Size A3 | Scale 1:12 U.O.S |  |

DO NOT SCALE – IF IN DOUBT ASK



Stowting Common, Near Ashford, Kent. TN25 6BN  
 Telephone: 01233 750393 Fax: 01233 750403  
 Int. Tel: +44 (0)1233 750393  
 www.jacksons-fencing.co.uk  
 www.jacksons-security.co.uk

TITLE JAKOUSTIC GATE SALES DRAWING  
 TIMBER BRACED – WITH CAPPING

CUSTOMER

Drawing No.

J7/02175

SHEET 2 OF 6

This Drawing Is The Property Of H.S. Jackson & Son (Fencing) Ltd.  
 And May Not Be Copied Or Reproduced In Any Way Without Prior Written Permission.

ACK No.