

BARBICAN IMPERIAL® RESIDENTIAL

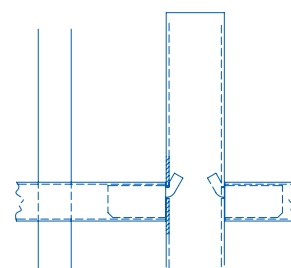

These striking steel vertical railings deliver an imposing first impression for any garden or housing project. The panel is constructed so the pale goes through the rail, ensuring there are no visible joins and anti-vandal fixings are used to attach the panel to its post, enhancing the fencing's security credentials.

- Standard height 1000mm and 1250mm
- 119mm pale pitch
- 19mm pales
- Flat top pales as standard
- 25-year service life guarantee



Post to panel fixings

APPLICATIONS

- ✓ Parks
- ✓ Public areas
- ✓ Schools

PANELS

Barbican Imperial® Residential panels have two horizontal rectangular hollow section rails 50 x 25mm; walls 2mm thick. The vertical round hollow section 19mm pales are passed through the rails with standard spacing at 119mm centres and welded into position.

GATES

Matching gates available

FINIAL OPTIONS

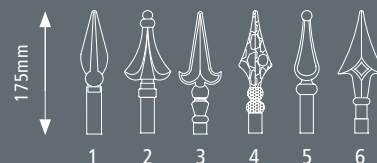

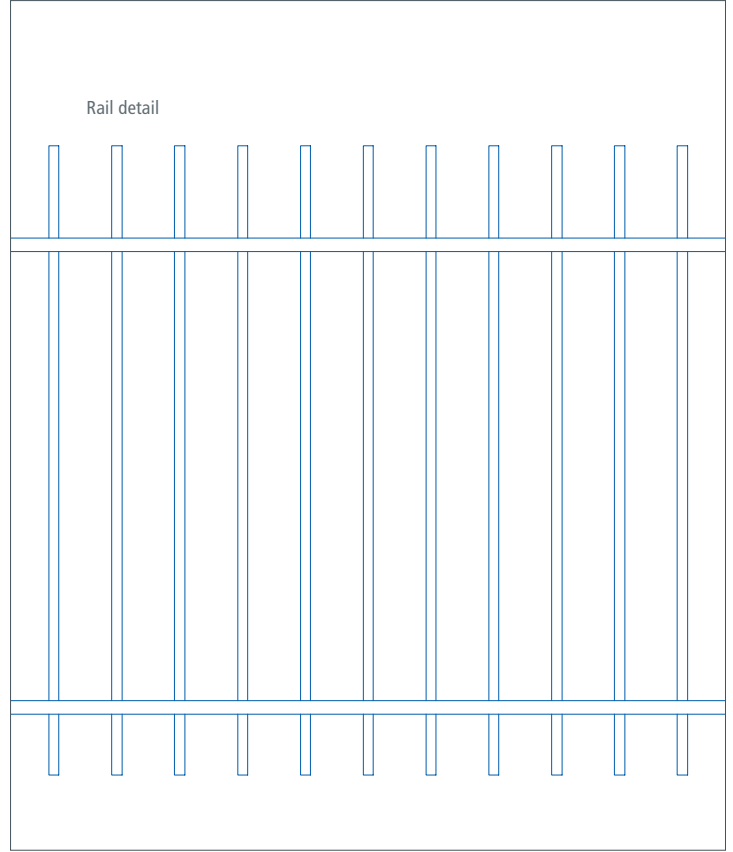

HEIGHT (MM)	POST CENTRES (MM)	POST DIMENSIONS (MM)	OVERALL POST LENGTH (MM)
1000	3000	60 x 60	1600
1250	3000	60 x 60	1850

POST OPTIONS

- Overlength set in concrete as standard
- Cranked to suit wall mounting

FINISHES

- Hot dip galvanised to BS EN ISO 1461 as standard
- Hot dip galvanised and powder coated to BS EN 13438
- Marine coat for installations within 500m of salt water or an estuary

STANDARD COLOURS

- Black RAL 9005
- Green RAL 6005
- Other colours are available on request