

FOR OPTIONAL FINIAL TOPPINGS
REFER TO DRAWING J1/01064

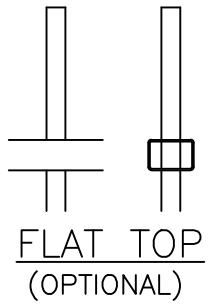

BASEPLATES SLOTTED FOR
M12 CHEMICAL FIXINGS

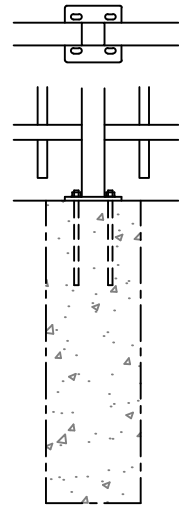

OPTIONAL
BASEPLATED POSTS

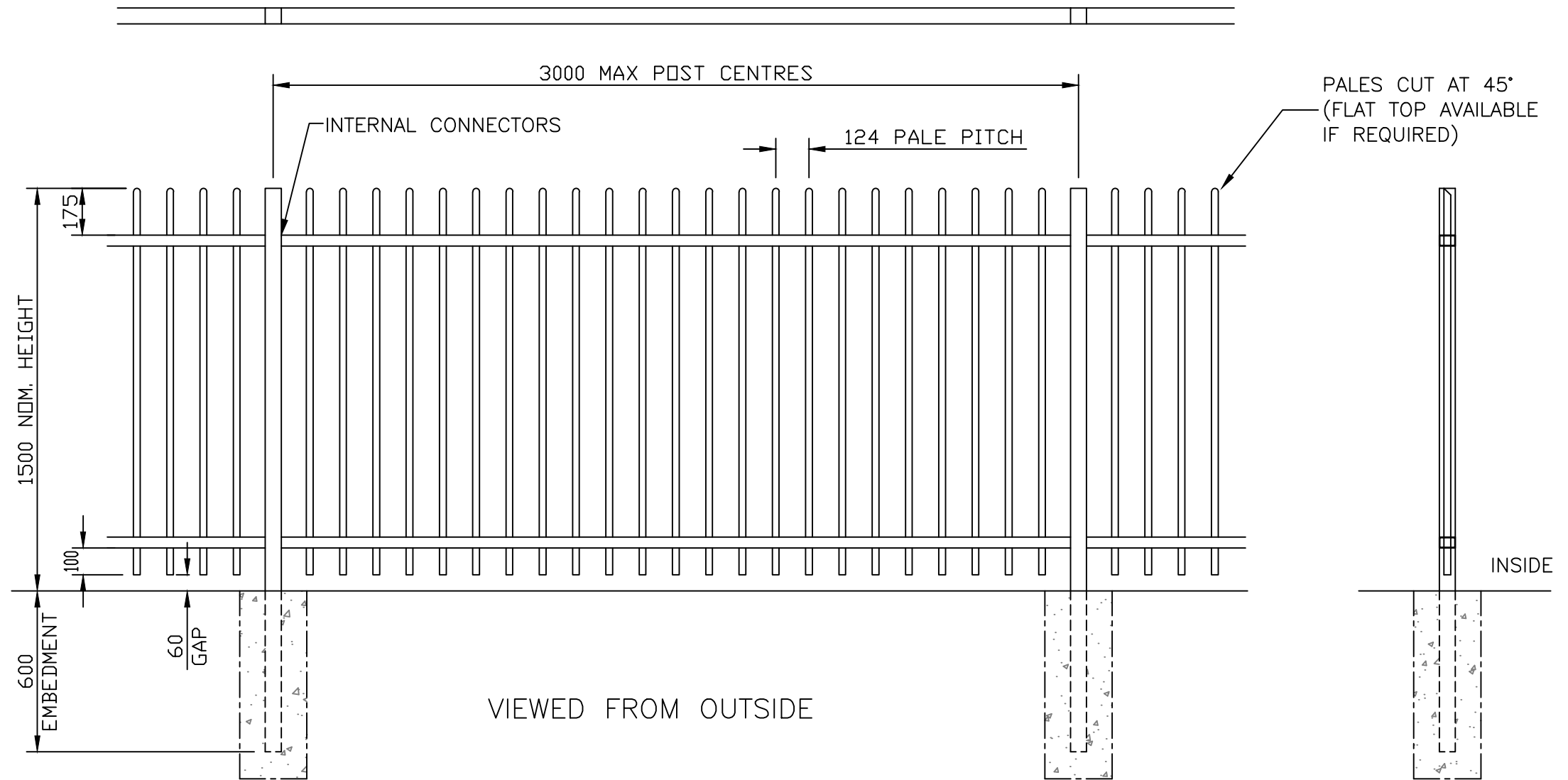

NOTES.

ALL DIMENSIONS ARE IN mm (UNO)
GAPS UNDER FENCING ARE
NOMINAL DUE TO GROUND LEVELS.
FOUNDATION SIZES ARE DEPENDANT
UPON SITE CONDITIONS.

MATERIALS.

FENCE POST: 60 x 60 SHS (TYPICAL)
(ASSESSED TO SUIT SITE LOCATION)
RAILS: 60 x 40 RHS
PALES: ø25 CHS

FINISH.

GALVANISED TO BS EN ISO 1461
POWDER COATED: IF REQUESTED

| | |
|--|---|
| | Stowting Common, Near Ashford, Kent. TN25 6BN Telephone: 01233 750393 Fax: 01233 750403 www.jacksons-fencing.co.uk www.jacksons-security.co.uk |
| | This Drawing Is The Property Of H.S. Jackson & Son (Fencing) Ltd, And May Not Be Copied Or Reproduced In Any Way Without Prior Written Permission. |

DO NOT SCALE – IF IN DOUBT ASK

| | | |
|---|------------|--------------------|
| 3 | 26/02/2020 | NEW BORDER + NOTES |
| 2 | 29.01.14 | Galv Note Updated |
| 1 | 22/01/10 | UPDATED |
| 0 | 23/05/00 | ORIGINAL ISSUE |

| | |
|---------|---------------|
| Drawn | CAJ |
| Date | 23/05/00 |
| Checked | CJ |
| Size | A3 |
| Scale | 1:20 U.O.S |

| | |
|-------------|-----------------------------------|
| TITLE | SALES DRAWING |
| | 1.5m HIGH BARBICAN IMPERIAL FENCE |
| CUSTOMER | |
| ACK No. | |
| Drawing No. | J1/01064 |
| | Sheet 9 |