

GATES SECURED USING PADLOCKABLE SLIDE LATCH (PADLOCK NOT SUPPLIED)
FOR OPTIONAL KEY LOCK REFER TO DRAWING J1/02111 FOR DETAILS.

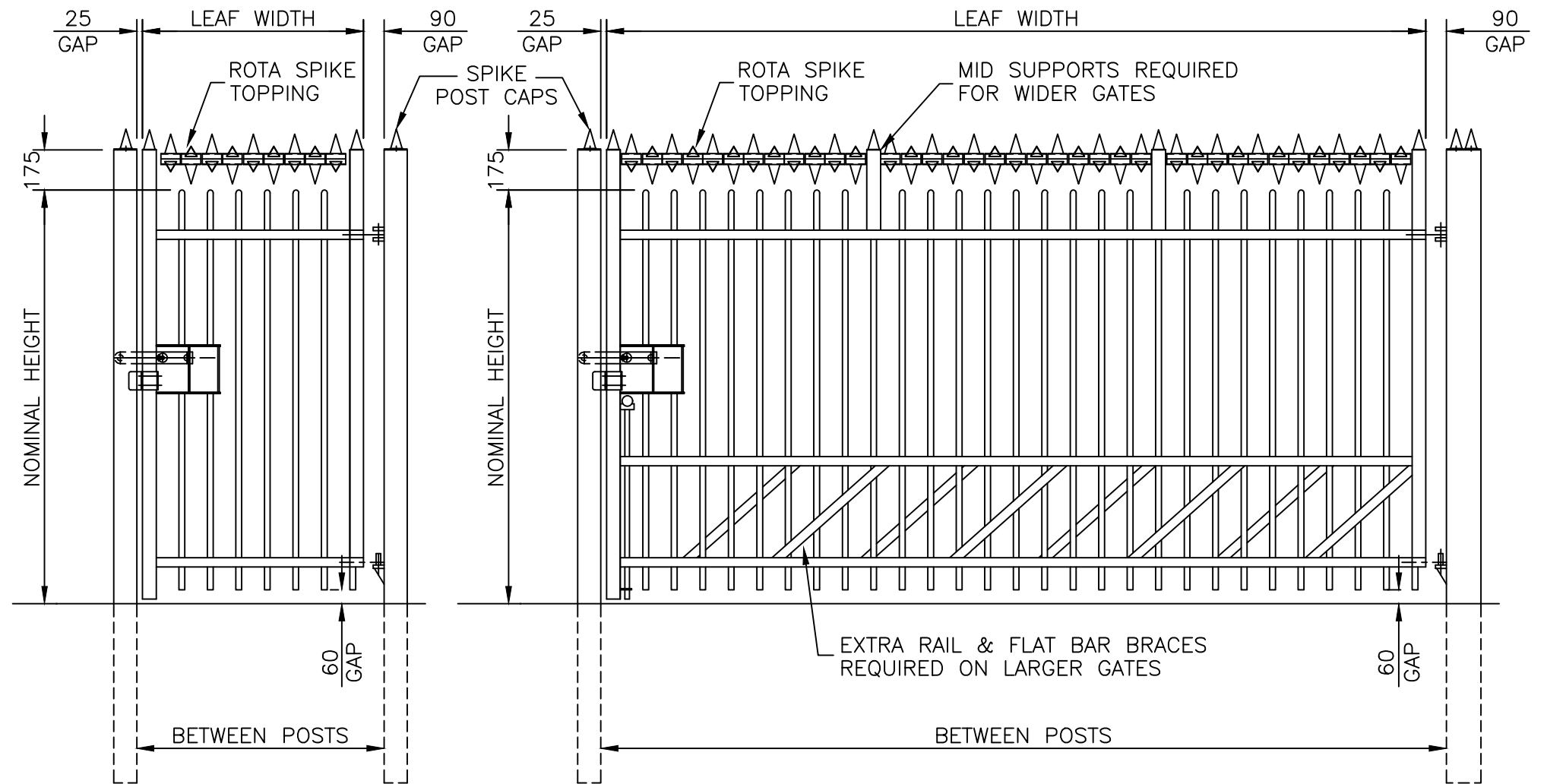

VIEWED FROM OUTSIDE
GATE OPENS AWAY FROM VIEWER
RIGHT HAND HANG AS SHOWN

124 PALE PITCH (AS DRAWN)

VIEWED FROM OUTSIDE
GATE OPENS AWAY FROM VIEWER
RIGHT HAND HANG AS SHOWN

124 PALE PITCH (AS DRAWN)

REFER TO SHEET 1 FOR
INSTALL DETAILS

NOTES.
ALL DIMENSIONS ARE IN mm (UNO)
GAPS UNDER GATES & FENCING
ARE NOMINAL DUE TO GROUND LEVELS.
REFER TO DRAWING J1/04047 FOR
GATE SIZE RANGE & DIMENSIONS.

MATERIALS.
HANG POST: ASSESSED TO SUIT
SLAM POST: 100 x 100 SHS (TYPICALLY)
RAILS: 60 x 40 RHS
STILES: 60 x 60 SHS
PALES: UPTO 2m High: Ø25 CHS @ 124 PALE PITCH
PALES: ABOVE 2m High: Ø32 CHS @ 129 PALE PITCH

FINISH.
GALVANISED TO BS EN ISO 1461
POWDER COATED: IF REQUESTED

**Jacksons
Fencing**

Stowting Common, Near Ashford,
Kent. TN25 6BN
Telephone: 01233 750393
Fax: 01233 750403
www.jacksons-fencing.co.uk
www.jacksons-security.co.uk

This Drawing Is The Property Of H.S. Jackson & Son (Fencing) Ltd, And May
Not Be Copied Or Reproduced In Any Way Without Prior Written Permission.

DO NOT SCALE – IF IN DOUBT ASK

1 02/03/2020 NEW BORDER – LATCH – NOTES
0 22/09/08 ORIGINAL ISSUE

Drawn SL
Date 22/09/2008
Checked CJ
Size A3
Scale 1:25
U.O.S

TITLE SALES DRAWING
BARBICAN IMPERIAL SINGLE GATES + ROTASPIKE TOPPING
CUSTOMER
ACK No.
Drawing No.
J1/02150
Sheet 3