

# BARBICAN IMPERIAL®

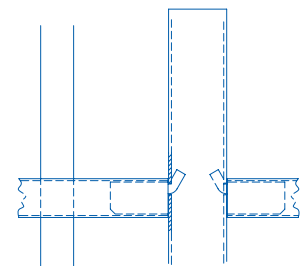

Barbican Imperial® with its 25mm (up to 2000mm in height) and 32mm diameter round pales (above 2000mm) delivers all the advantages of the Barbican® range with no reduction in strength or security. Barbican Imperial® is available with a choice of decorative finials and post tops to offer the right solution for even the most prestigious applications.

- Posts can be customised for Barbed wire / Razor wire / Rota Spike® / Alarm-aFence®
- Vertical pale spacing conforms to building regulations for anti-trap
- Unique vandal-proof panel to post connectors
- Panels can be manufactured to accommodate sloping ground
- Anti-climb design
- 25-year service life guarantee



Post to panel fixings

## APPLICATIONS

- ✓ Perimeters
- ✓ Medium - High risk
- ✓ Schools

## PANELS

Barbican Imperial® comprises of vertical round hollow section 25mm diameter pales up to 2000mm high at 124mm centres and 32mm for 2100mm+ with 129mm centres.

Panels under 1200mm come with flat top pales as standard, with an option of a pointed top. Panels 1500mm and above come with pales cut at 45°.

## GATES

Matching gates available

## FINIAL OPTIONS



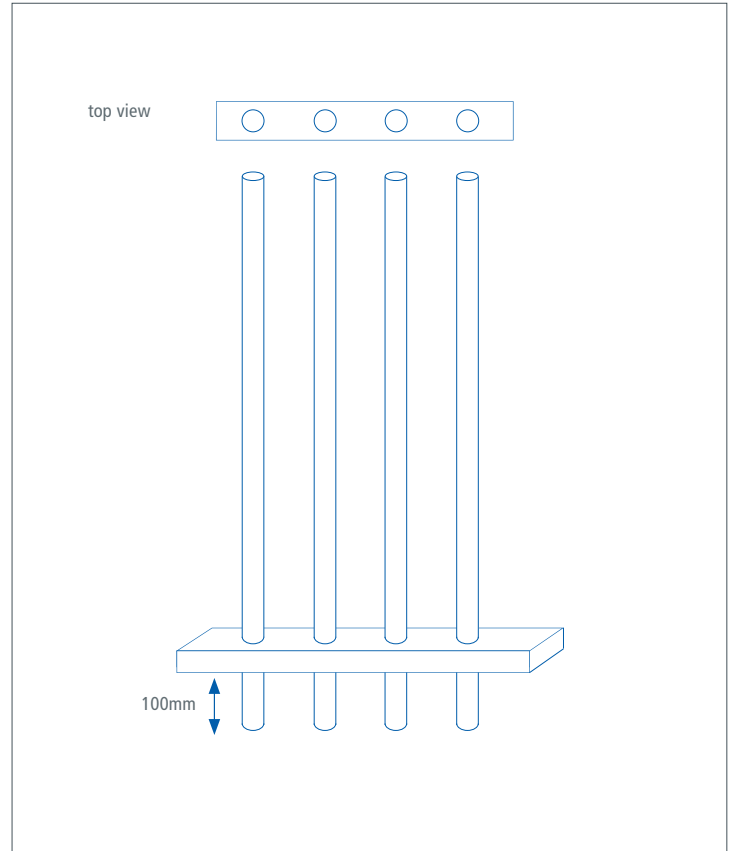

HEIGHT (MM)	POST CENTRES (MM)	POST DIMENSIONS (MM)	OVERALL POST LENGTH (MM)
1000	3000	60 x 60	1600
1250	3000	60 x 60	1850
1500	3000	60 x 60	2100
1800	3000	60 x 60	2500
2000	3000	60 x 60	2800
2500	3000	80 x 60	3300
3000	2484	80 x 60	3800

► Option of plastic dome caps

### POST OPTIONS

- Overlength set in concrete as standard
- Baseplated to bolt down onto concrete
- Cranked to suit wall mounting

### FINISHES

- Hot dip galvanised to BS EN ISO 1461 as standard
- Hot dip galvanised and powder coated to BS EN 13438
- Marine coat for installations within 500m of salt water or an estuary

### STANDARD COLOURS

- Black RAL 9005
- Green RAL 6005
- Other colours are available on request