

**NOTES.**

ALL DIMENSIONS ARE IN mm (UNO)  
 GAPS UNDER FENCING ARE NOMINAL DUE TO GROUND LEVELS.  
 CAPPING & COUNTER RAILS MAYBE REMOVE IF NOT REQUIRED  
 (PLEASE ASK SALES FOR FURTHER DETAIL)

**MATERIALS.**

- ACOUSTIC BOTTOM BOARD: 140 x 34 thk (120 Nom. FACE)
- ACOUSTIC T & G BOARD: 140 x 34 thk (123 Nom. FACE)
- CAPPING RAIL: 145 x 34 thk PAR
- COUNTER RAIL: 70 x 34 thk PAR
- POST COVER BOARD: 120 x 35 thk
- TIMBER BATTEN: 100 x 50 thk SAWN FINISH
- STEEL POSTS: UNIVERSAL BEAMS ASSESSED TO SUIT SITE LOCATION.
- ALL FIXINGS ARE GALVANISED OR STAINLESS STEEL.

**FINISH.**

TIMBER: JAKCURED TREATED.  
 STEEL: GALVANISED TO BS EN ISO 1461

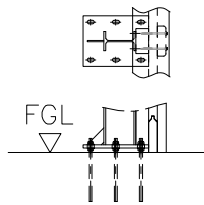

BASEPLATE OPTION  
 (REFER TO DRAWING J7/01296 FOR MORE DETAILS)

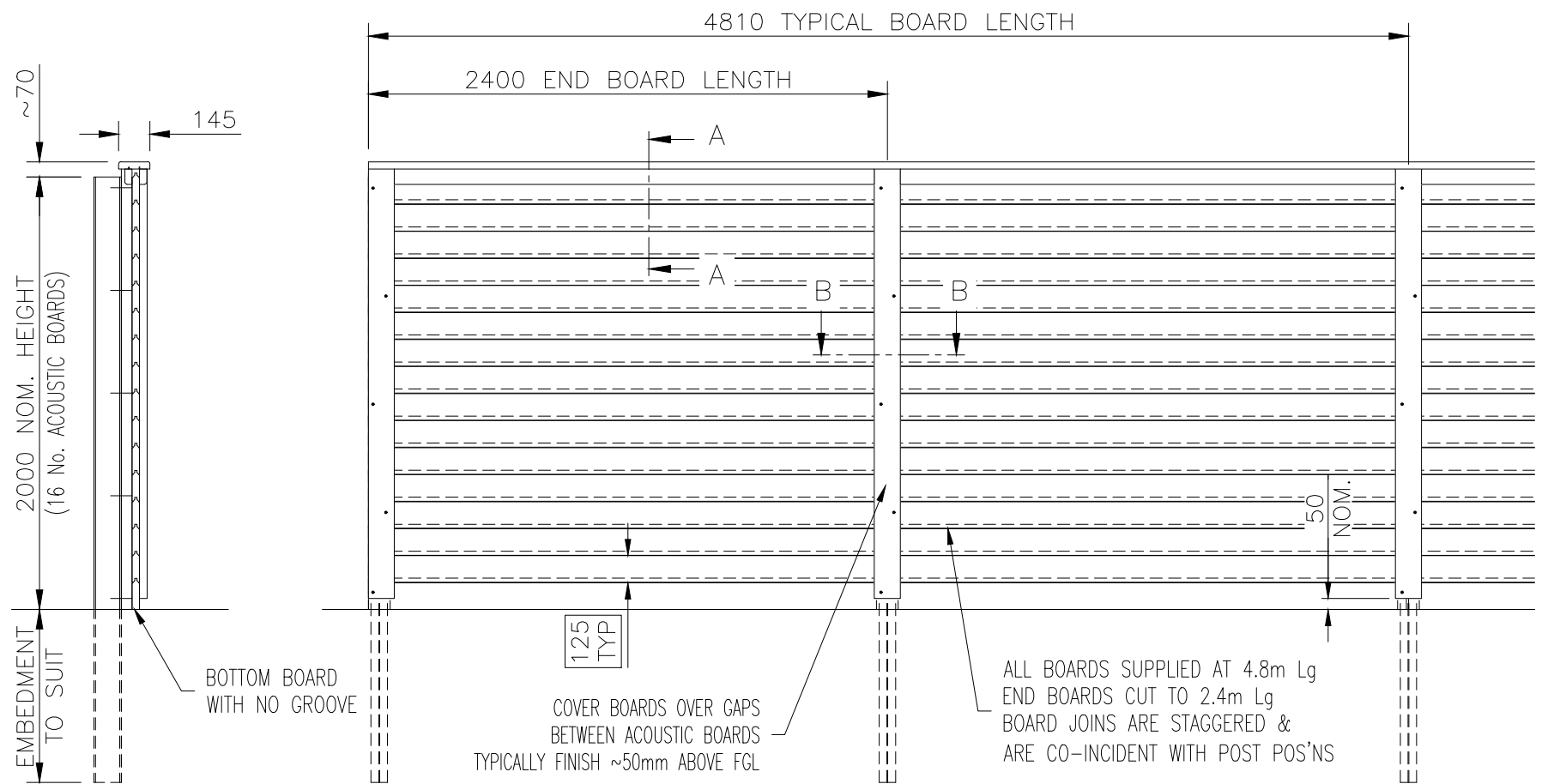
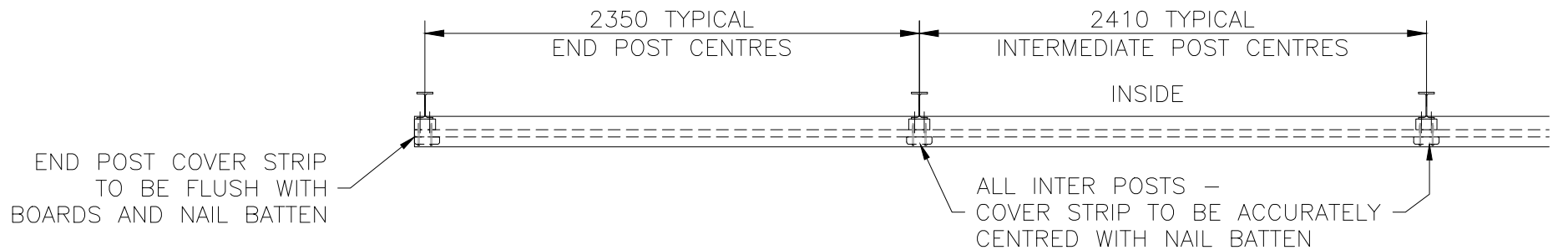

JAKOUSTIC HIGHWAY FENCE (WITH CAPPING) - 2m HIGH

**Jacksons Fencing**  
 Stowting Common, Near Ashford, Kent. TN25 6BN  
 Telephone: 01233 750393  
 Fax: 01233 750403  
 www.jacksons-fencing.co.uk

This Drawing Is The Property Of H.S. Jackson & Son (Fencing) Ltd, And May Not Be Copied Or Reproduced In Any Way Without Prior Written Permission.

DO NOT SCALE - IF IN DOUBT ASK

8	27/03/2020	NEW BORDER + NOTES
7	01/05/19	UPDATE
6	07/05/16	TIMBER MAT'LS CORRECTED
5	16/08/16	POST MATERIAL NOTE
4	01/02/13	Post Centres Now 2410

Drawn JR	TITLE SALES DRAWING (WITH CAPPING) JAKOUSTIC HIGHWAY FENCE - 2m HIGH
Date 11/06/2007	
Checked AT	CUSTOMER
Size A3	Scale 1:30 U.O.S
ACK No.	
Drawing No. J7/01047	
Sheet 1	