

BASEPLATES SLOTTED FOR
M12 CHEMICAL FIXINGS

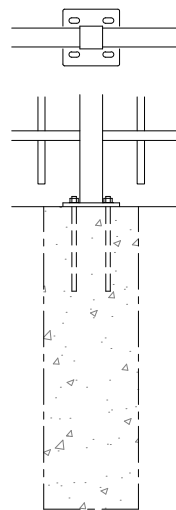

OPTIONAL
BASEPLATED POSTS

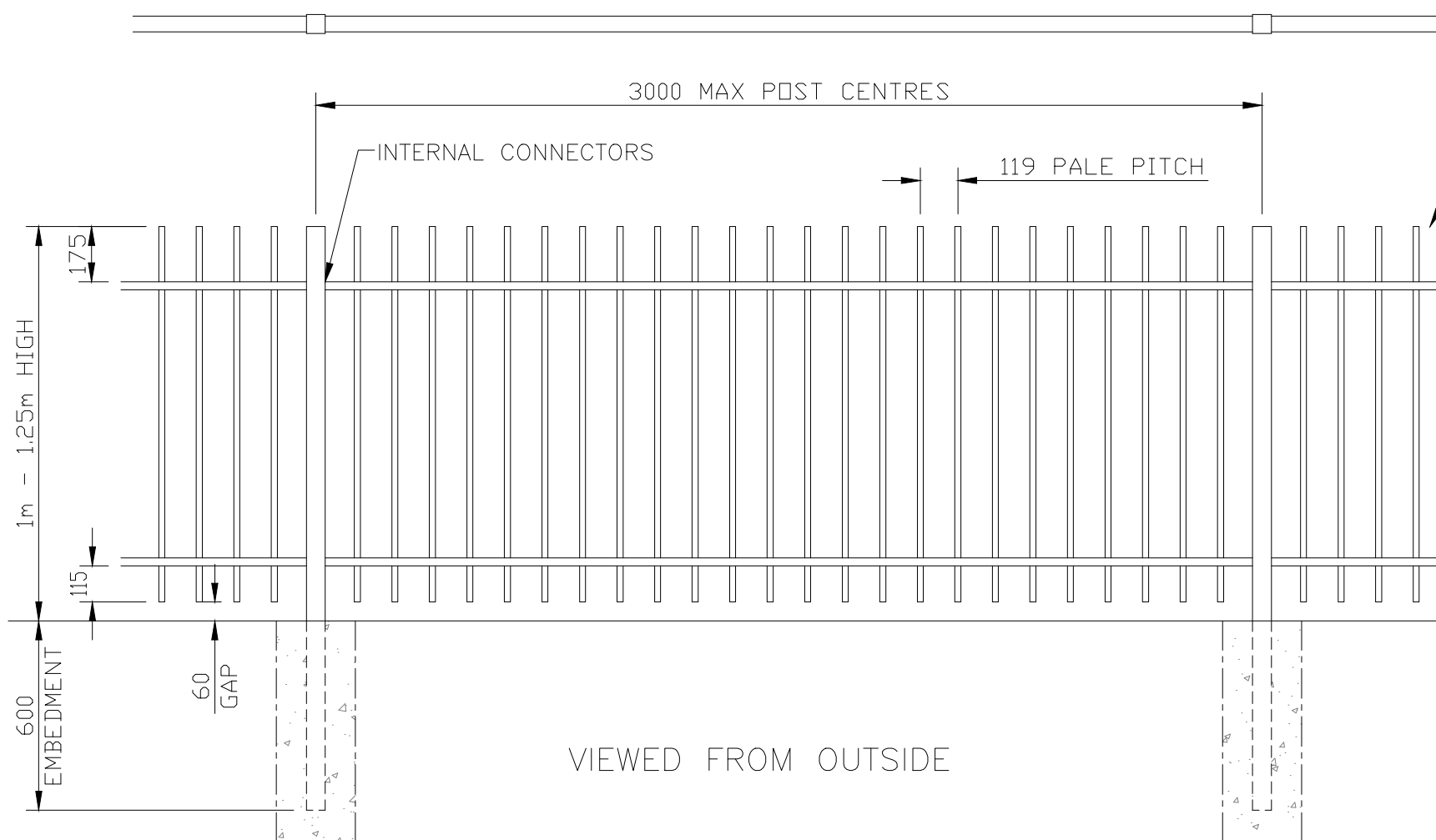

FLAT TOP PALES AS STANDARD.
(CAN BE PLUGGED IF REQUIRED)
POINTED TOP AVAILABLE IF REQUIRED
BUT ONLY IF OVERALL FENCE HEIGHT
IS 1.5m MIN FROM GROUND LEVEL

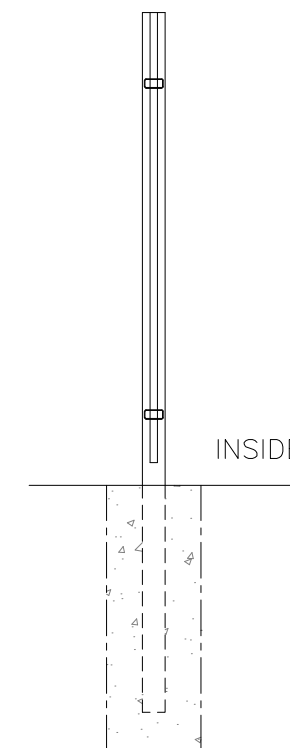

NOTES.

ALL DIMENSIONS ARE IN mm (UNO)
GAPS UNDER FENCING ARE
NOMINAL DUE TO GROUND LEVELS.
FOUNDATION SIZES ARE DEPENDANT
UPON SITE CONDITIONS.

MATERIALS.

FENCE POST: 60 x 60 SHS (TYPICAL)
(ASSESSED TO SUIT SITE LOCATION)
RAILS: 50 x 25 RHS
PALES: ϕ 19 CHS

FINISH.

GALVANISED TO BS EN ISO 1461
POWDER COATED: IF REQUESTED

**Jacksons
Fencing**

Stowting Common, Near Ashford,
Kent. TN25 6BN
Telephone: 01233 750393
Fax: 01233 750403
www.jacksons-fencing.co.uk

This Drawing Is The Property Of H.S. Jackson & Son (Fencing) Ltd, And May
Not Be Copied Or Reproduced In Any Way Without Prior Written Permission.

DO NOT SCALE – IF IN DOUBT ASK

- ⑥ 26/02/2020 NEW BORDER + NOTES
- ⑤ 13/03/18 FINIALS
- ④ 26/04/17 Section through updated
- ③ 29/01/14 Galv Note Updated
- ② 09/01/14 Finial Heights Added

Drawn	CP
Date	14/09/10
Checked	CJ
Size	A3
Scale	1:20 U.O.S

TITLE 1m – 1.25m HIGH FENCE SALES DRAWING BARBICAN IMPERIAL 'RESIDENTIAL'	
CUSTOMER	Drawing No.
ACK No.	J1/01064 Sheet 8a