

BASEPLATE SLOTTED FOR M12 CHEMICAL FIXINGS

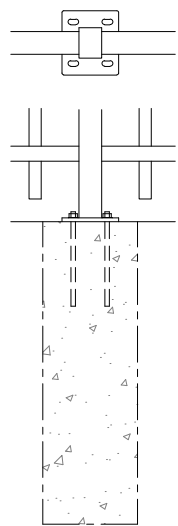

OPTIONAL
BASEPLATED POSTS

NOTES.

ALL DIMENSIONS ARE IN mm (UNO)
GAPS UNDER FENCING ARE NOMINAL DUE TO GROUND LEVELS.
FOUNDATION SIZES ARE DEPENDANT UPON SITE CONDITIONS.

MATERIALS.

FENCE POST: 80 x 60 RHS (TYPICAL)
(ASSESSED TO SUIT SITE LOCATION)
RAILS: 60 x 40 RHS
PALES: 25 x 25 SHS

FINISH.

GALVANISED TO BS EN ISO 1461
POWDER COATED: IF REQUESTED

Jacksons Fencing

Stowting Common, Near Ashford,
Kent. TN25 6BN
Telephone: 01233 750393
Fax: 01233 750403
www.jacksons-fencing.co.uk

DO NOT SCALE – IF IN DOUBT ASK

- 3 26/02/2020 NEW BORDER + NOTES
- 2 29.01.14 Galv Note Updated
- 1 25/01/10 UPDATED
- 0 23/05/00 ORIGINAL ISSUE

Drawn	CAJ
Date	23/05/00
Checked	CJ
Size	A3
Scale	1:20 U.O.S

TITLE	SALES DRAWING
	2.5m HIGH BARBICAN EXTRA FENCE
CUSTOMER	
ACK No.	
Drawing No.	J1/01064
	Sheet 15

This Drawing Is The Property Of H.S. Jackson & Son (Fencing) Ltd, And May Not Be Copied Or Reproduced In Any Way Without Prior Written Permission.