

FOR OPTIONAL FINIAL TOPPINGS  
REFER TO DRAWING J1/01064

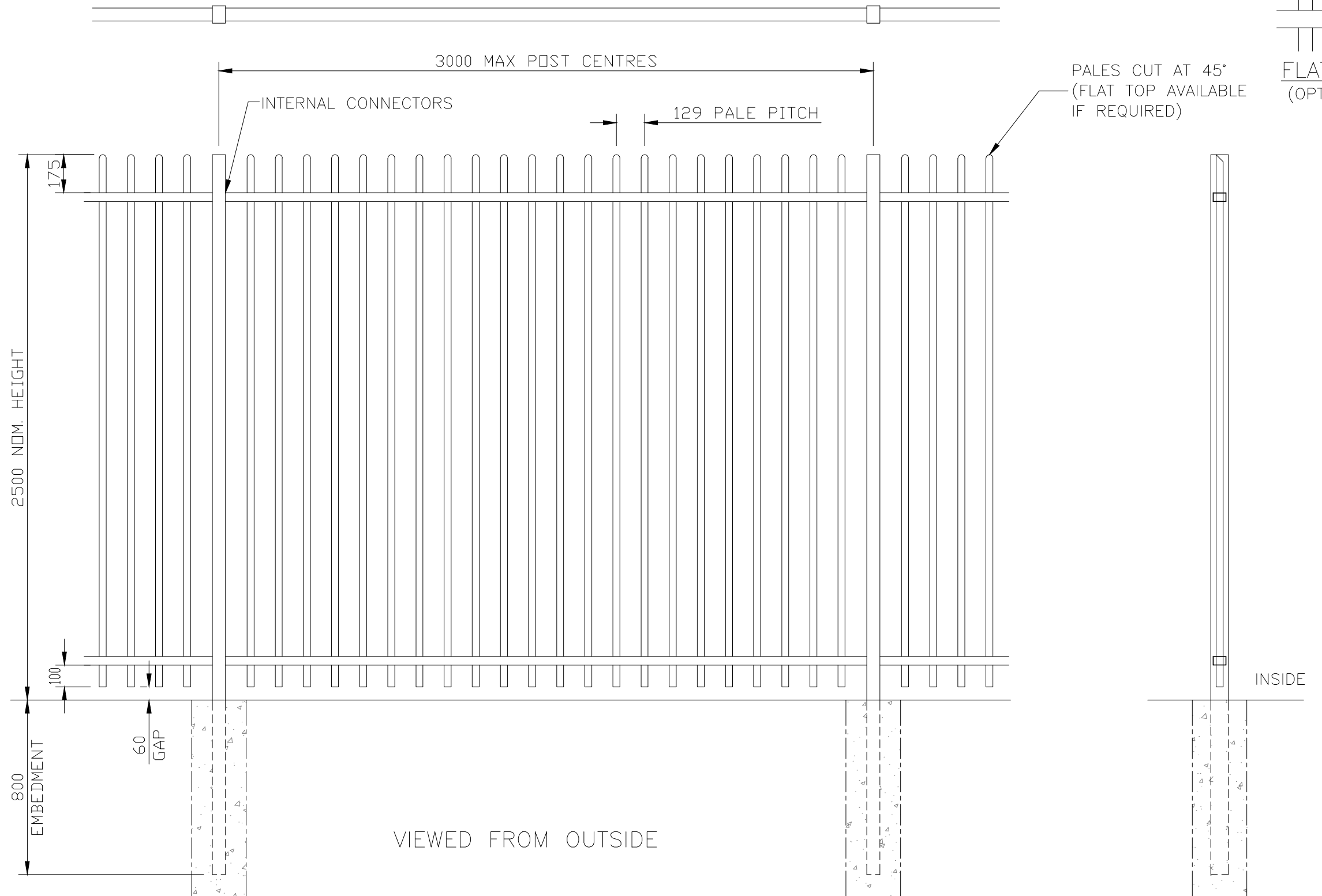

BASEPLATE SLOTTED FOR  
M12 CHEMICAL FIXINGS

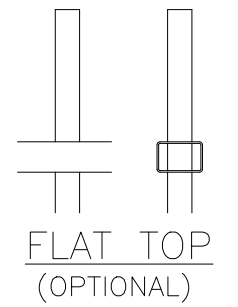
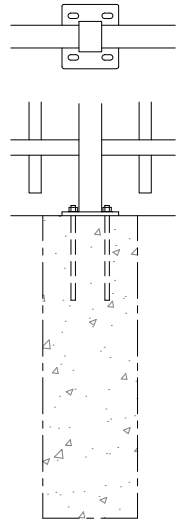

OPTIONAL  
BASEPLATED POSTS

**NOTES.**

ALL DIMENSIONS ARE IN mm (UNO)  
GAPS UNDER FENCING ARE  
NOMINAL DUE TO GROUND LEVELS.  
FOUNDATION SIZES ARE DEPENDANT  
UPON SITE CONDITIONS.

**MATERIALS.**

FENCE POST: 80 x 60 RHS (TYPICAL)  
(ASSESSED TO SUIT SITE LOCATION)  
RAILS: 60 x 40 RHS  
PALES:  $\phi 25$  CHS

**FINISH.**

GALVANISED TO BS EN ISO 1461  
POWDER COATED: IF REQUESTED

**Jacksons  
Fencing**

Stowting Common, Near Ashford,  
Kent. TN25 6BN  
Telephone: 01233 750393  
Fax: 01233 750403  
www.jacksons-fencing.co.uk

DO NOT SCALE – IF IN DOUBT ASK

- 3 26/02/2020 NEW BORDER + NOTES
- 2 29.01.14 Galv Note Updated
- 1 22/01/10 UPDATED
- 0 23/05/00 ORIGINAL ISSUE

Drawn	CAJ
Date	23/05/00
Checked	CJ
Size	A3
Scale	1:20 U.O.S

TITLE	SALES DRAWING
	2.5m HIGH BARBICAN IMPERIAL FENCE
CUSTOMER	
ACK No.	
Drawing No.	J1/01064
	Sheet 12

This Drawing Is The Property Of H.S. Jackson & Son (Fencing) Ltd, And May Not Be Copied Or Reproduced In Any Way Without Prior Written Permission.